

Features

- Halogen Free Available Upon Request By Adding Suffix "-HF"
- Moisture Sensitivity Level 1
- Epoxy Meets UL 94 V-0 Flammability Rating
- Lead Free Finish/RoHS Compliant (Note1) ("P" Suffix Designates RoHS Compliant. See Ordering Information)

Maximum Ratings @ 25°C Unless Otherwise Specified

- Operating Junction Temperature Range: -55°C to +150°C
- Storage Temperature Range: -55°C to +150°C
- Thermal Resistance: 62.5°C/W Junction to Ambient
- Thermal Resistance: 1.92°C/W Junction to Case

Parameter	Symbol	Rating	Unit
Collector-Base Voltage	V_{CBO}	80	V
Collector-Emitter Voltage	V_{CEO}	80	V
Emitter-Base Voltage	V_{EBO}	5	V
Continuous Collector Current	I_C	10	A
Peak Collector Current	I_{CM}	15	A
Continuous Base Current	I_B	250	mA
Power Dissipation Derate Above 25°C	$T_A=25^\circ\text{C}$	P_D	W
	$T_C=25^\circ\text{C}$		

Note: 1.High Temperature Solder Exemption Applied, see EU Directive Annex 7.

Marking: 2N6388

**NPN Darlington
Power Transistor**

TO-220

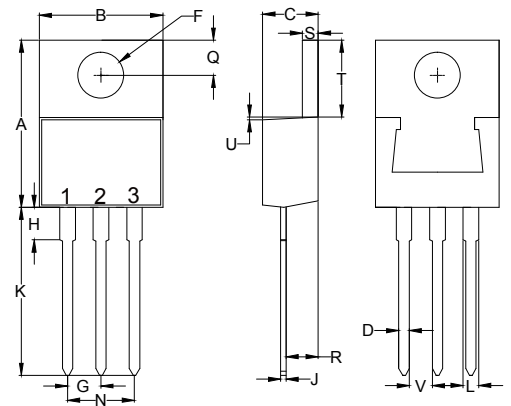

1.BASE
2.COLLECTOR
3.EMITTER

DIM	INCHES		MM		NOTE
	MIN	MAX	MIN	MAX	
A	0.560	0.625	14.22	15.88	
B	0.380	0.420	9.65	10.67	
C	0.140	0.190	3.56	4.82	
D	0.020	0.045	0.51	1.14	
F	0.139	0.161	3.53	4.09	Φ
G	0.090	0.110	2.29	2.79	
H	----	0.250	----	6.35	
J	0.012	0.025	0.30	0.64	
K	0.500	0.580	12.70	14.73	
L	0.045	0.060	1.14	1.52	
N	0.190	0.210	4.83	5.33	
Q	0.100	0.135	2.54	3.43	
R	0.080	0.115	2.04	2.92	
S	0.045	0.055	1.14	1.39	
T	0.230	0.270	5.84	6.86	
U	----	0.050	----	1.27	
V	0.045	----	1.15	----	

Electrical Characteristics @ T_A=25°C Unless Otherwise Specified

Parameter	Symbol	Min	Typ	Max	Units	Conditions
Collector-Emitter Breakdown Voltage	V _{(BR)CEO}	80			V	I _C =200mA, I _B =0
Collector Cutoff Current	I _{CEO}			1	mA	V _{CE} =80V, I _B =0
Collector Cutoff Current	I _{CEX}			300	μA	V _{CE} =80V, V _{EB(off)} =1.5V
				3	mA	V _{CE} =80V, V _{EB(off)} =1.5V, T _C =125°C
Emitter Cutoff Current	I _{EBO}			5	mA	V _{EB} =5V, I _C =0
DC Current Gain	h _{FE(1)}	1000		20000		V _{CE} =3V, I _C =5A
	h _{FE(2)}	100				V _{CE} =3V, I _C =10A
Collector-Emitter Saturation Voltage	V _{CE(sat)}			2.0	V	I _C =5A, I _B =0.01A
				3.0	V	I _C =10A, I _B =0.1A
Base-Emitter On Voltage	V _{BE(on)}			2.8	V	V _{CE} =3V, I _C =5A
				4.5	V	V _{CE} =3V, I _C =10A
Collector Output Capacitance	C _{ob}			200	pF	V _{CB} =10V, I _E =0, f=1MHz
Small-Signal Current Gain	h _{fe}	1000				I _C =1.0A, V _{CE} =5.0V, f=1.0MHz
Small-Signal Current Gain	h _{fe}	20				I _C =1.0A, V _{CE} =5.0V, f=1.0KHz

Curve Characteristics

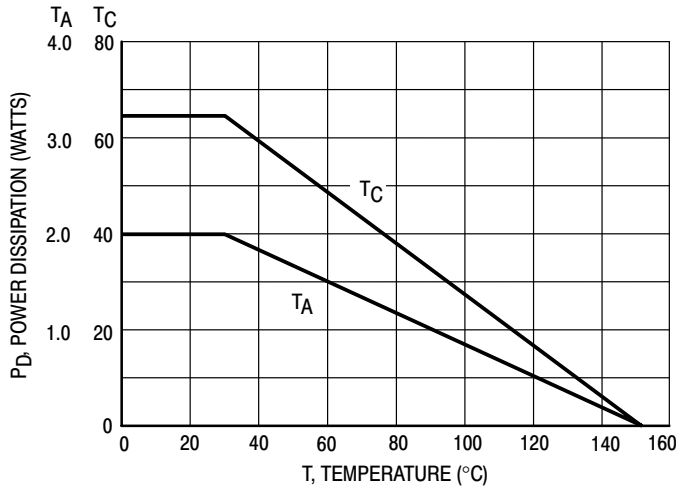

Figure 1. Power Derating

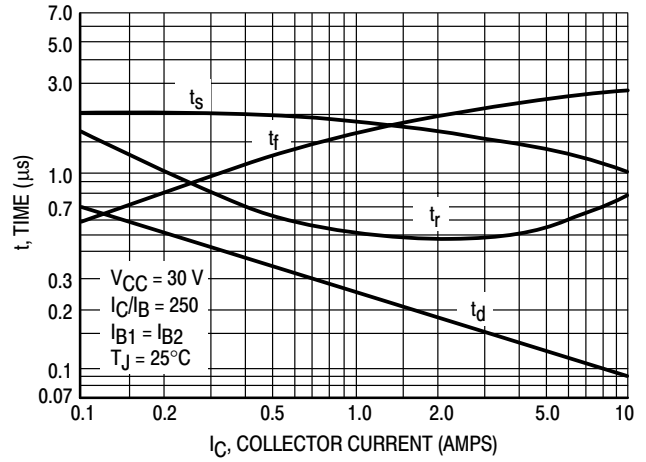

Figure 2. Switching Times

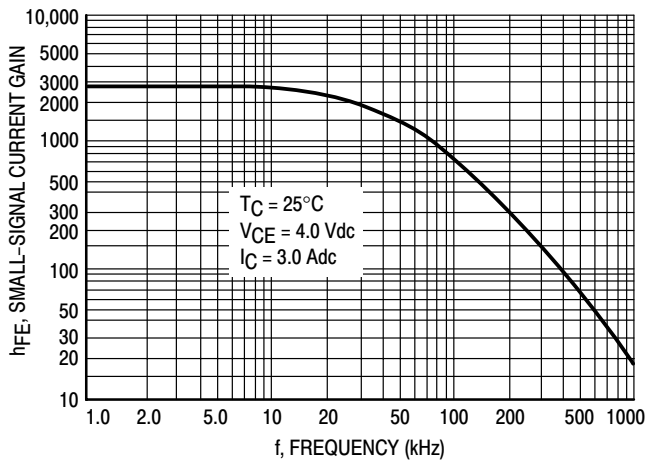

Figure 3. Small-Signal Current Gain

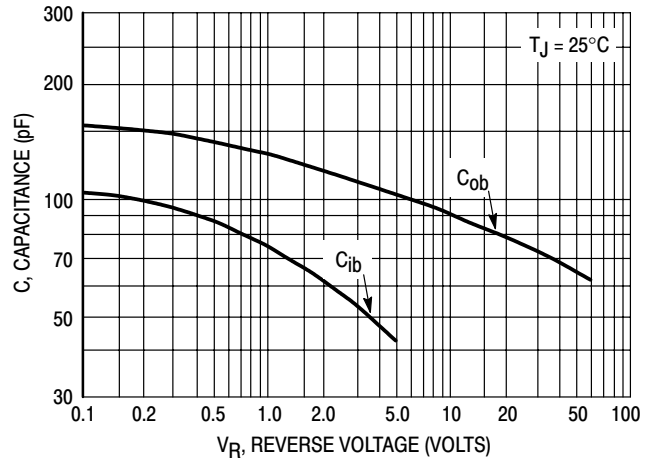

Figure 4. Capacitance

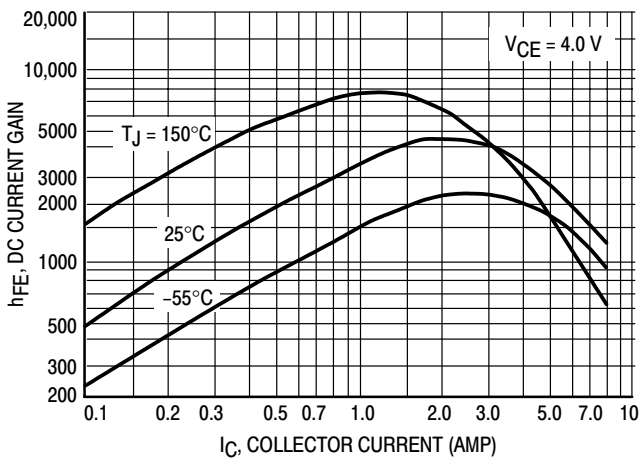

Figure 5. DC Current Gain

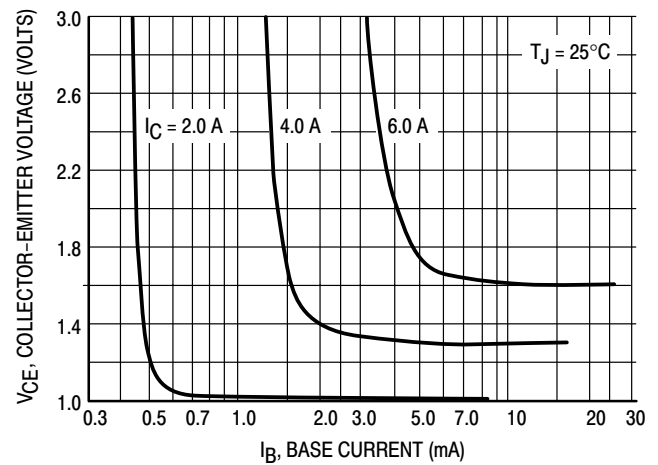

Figure 6. Collector Saturation Region

Curve Characteristics

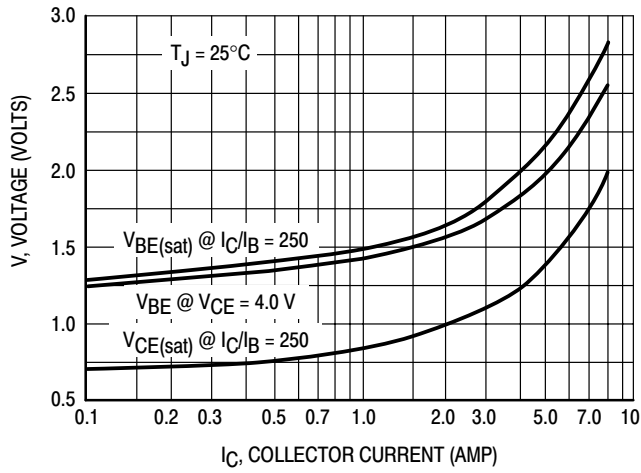

Figure 7. "On" Voltages

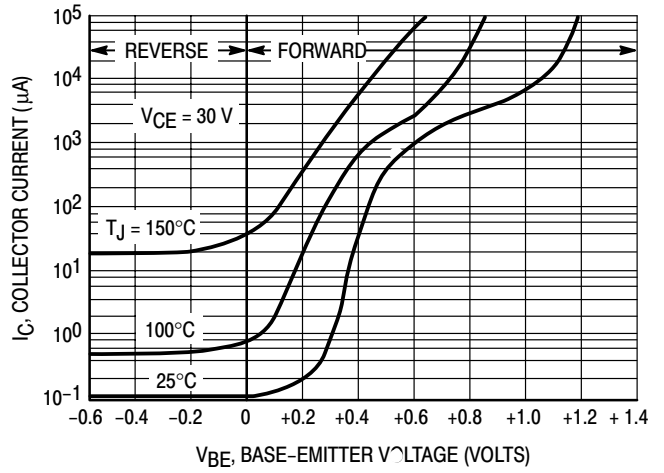

Figure 8. Collector Cut-Off Region

Ordering Information

Device	Packing
Part Number-BP	Bulk: 1Kpcs/Box

Note : Adding "-HF" Suffix for Halogen Free, eg. Part Number-BP-HF

*****IMPORTANT NOTICE*****

Micro Commercial Components Corp. reserves the right to make changes without further notice to any product herein to make corrections, modifications , enhancements , improvements , or other changes . **Micro Commercial Components Corp .** does not assume any liability arising out of the application or use of any product described herein; neither does it convey any license under its patent rights ,nor the rights of others . The user of products in such applications shall assume all risks of such use and will agree to hold **Micro Commercial Components Corp .** and all the companies whose products are represented on our website, harmless against all damages.

*****LIFE SUPPORT*****

MCC's products are not authorized for use as critical components in life support devices or systems without the express written approval of Micro Commercial Components Corporation.

*****CUSTOMER AWARENESS*****

Counterfeiting of semiconductor parts is a growing problem in the industry. Micro Commercial Components (MCC) is taking strong measures to protect ourselves and our customers from the proliferation of counterfeit parts. MCC strongly encourages customers to purchase MCC parts either directly from MCC or from Authorized MCC Distributors who are listed by country on our web page cited below. Products customers buy either from MCC directly or from Authorized MCC Distributors are genuine parts, have full traceability, meet MCC's quality standards for handling and storage. **MCC will not provide any warranty coverage or other assistance for parts bought from Unauthorized Sources.** MCC is committed to combat this global problem and encourage our customers to do their part in stopping this practice by buying direct or from authorized distributors.